

BLOOM TOWNSHIP SECTION 24 R13 TWP 10 MORGAN COUNTY, OH

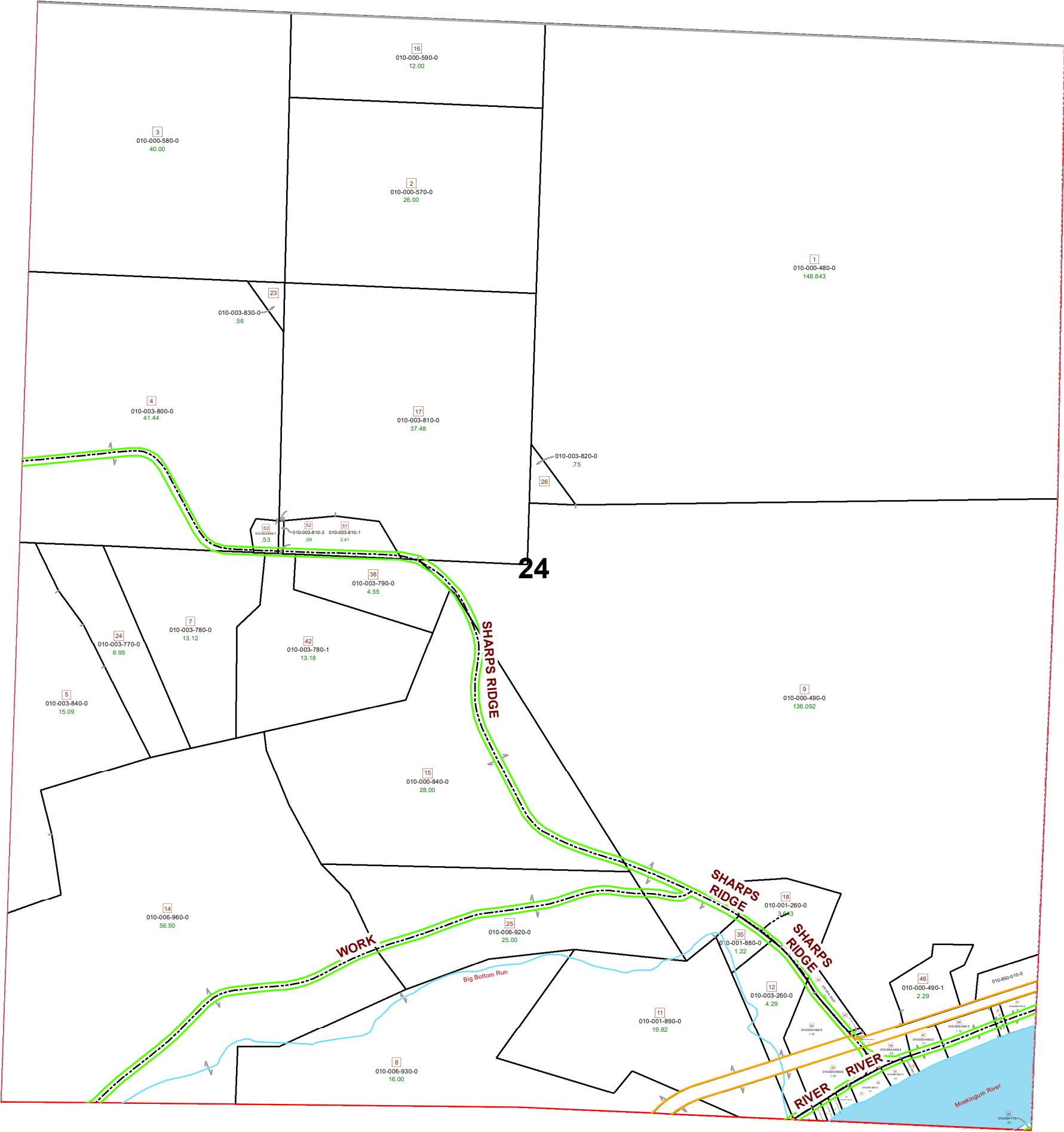

PIN	VOL	PAG	Owner	LegalDescr	Acres
010-003-840-0	OR222	1	BAKER JOSHUA A	R13 T10 S24 SD 5	15.097
010-000-570-0	OR221	930	BROOKS HAROLD K & JOYCE M TOD-RU	R13 T10 S24 SD 2	26
010-000-580-0	OR221	930	BROOKS HAROLD K & JOYCE M TOD-RU	R13 T10 S24 SD 3	40
010-000-590-0	OR221	928	BROOKS RUSSELL JOHNATHON & NATA	R13 T10 S24 SD 16	12
010-003-020-0	OR209	2578	CHRISTY JOHN R	R13 T10 S24 SD 27-	0.509
010-000-840-0	OR69	173	CLEMENTS TROY MILLER	R13 T10 S24 SD 15	28
010-850-010-0	D.V	36	257 CSX TRANSPORTATION INC TAX DEPAR	RAILROAD	1
010-001-260-0	OR215	2915	DEARSTINE WALTER R	R13 T10 S24 SD 18	3.613
010-000-080-0	OR 231	3548	DURANT HISTORICAL VILLAGE INC	R13 T10 S24 SD 41	0.031
010-000-490-3	OR 231	3548	DURANT HISTORICAL VILLAGE INC	R13 T10 S24 SD 48	1.129
010-000-490-0	OR 231	3548	DURANT HISTORICAL VILLAGE INC	R13 T10 S24 SD 9	136.09
010-000-480-0	OR 231	3548	DURANT HISTORICAL VILLAGE INC	R13 T10 S24 SD 1	148.64
010-005-740-0	OR13	254	FERRIS SHERYL SINGLETON GEORGE W	R13 T10 S24 SD 40	0.19
010-005-730-0	OR13	252	FERRIS SHERYL SINGLETON GEROGUE W	R13 T10 S24 SD 22	0.58
010-001-810-0	OR203	2389	FOSTER JACK D & RICHARDSON JANICE	R13 T10 S24 SD 30	0.084
010-001-820-0	OR203	2389	FOSTER JACK D & RICHARDSON JANICE	R13 T10 S24 SD 29	0.15
010-001-890-0	D.V	149	1 FOSTER JOHN D AKA JACK	R13 T10 S24 SD 11	19.82
010-001-880-0	D.V	149	1 FOSTER JOHN D AKA JACK	R13 T10 S24 SD 35	1.22
010-006-930-0	OR209	2989	HIV/NOR RAYMOND A & DEBORAH J & C	R13 T10 S24 SD 8 S	16
010-006-920-0	OR209	2989	HIV/NOR RAYMOND A & DEBORAH J & C	R13 T10 S24 SD 25	25
010-006-960-0	OR209	2989	HIV/NOR RAYMOND A & DEBORAH J & C	R13 T10 S24 SD 14	56.5
010-004-170-0	OR230	550	LYDELLE DEREK GLENN & AMY JO	R13 T10 S24 SD 21	0.04
010-004-160-0	OR230	550	LYDELLE DEREK GLENN & AMY JO	R13 T10 S24 SD 19-	0.639
010-004-770-1	OR227	2260	MCLAIN LEWIS R & PATRICIA A	R13 T10 S24 SD 43	0.063
010-000-490-6	OR226	3016	MILLER CHRIS & JULIA	R13 T10 S24 SD 45	1.482
010-003-790-0	OR192	175	MILLER MELVIN J & ESTHER E	R13 T10 S24 SD 38	4.55
010-003-810-2	OR195	502	MILLER MELVIN J & ESTHER E	R13 T10 S24 SD 52	0.097
010-003-830-0	D.V	151	689 MILLER MELVIN J & ESTHER E	R13 T10 S24 SD 23	0.56
010-003-800-0	D.V	151	689 MILLER MELVIN J & ESTHER E	R13 T10 S24 SD 4 S	40.907
010-003-780-1	OR192	175	MILLER THOMAS M & EDITH I	R13 T10 S24 SD 42	13.187
010-003-810-1	OR210	625	MILLER THOMAS M & EDITH I	R13 T10 S24 SD 51	2.417
010-003-820-0	D.V	161	219 MILLER THOMAS M & EDITH I	R13 T10 S24 SD 26	0.75
010-003-810-0	OR156	676	MILLER THOMAS M & EDITH I	R13 T10 S24 SD 17	37.486
010-003-800-1	OR215	3084	MILLER THOMAS M & EDITH I	R13 T10 S24 SD 53	0.533
010-003-780-0	OR192	175	MILLER TIMOTHY M	R13 T10 S24 SD 7	13.123
010-003-770-0	OR192	175	MILLER TIMOTHY M	R13 T10 S24 SD 24	6.95
010-003-260-1	OR207	1896	MUNYAN JOHN & CARLA	R13 T10 S24 SD 44	0.205
010-004-060-0	OR207	1896	MUNYAN JOHN & CARLA	R13 T10 S24 SD 31	0.13
010-003-260-0	D.V	191	580 RAINES ALLEN D & ERLENE M	R13 T10 S24 SD 12	4.295
010-000-490-5	OR225	3256	RUSSELL DARLA S	R13 T10 S24 SD 50	1.521
010-006-360-0	OR103	456	SHUSTER DONNA J ET AL	R13 T10 S24 SD 32	0.083
010-006-830-0	OR208	797	SIMMONS GARY & TERESSA	R13 T10 S24 SD 33	0.29
010-001-900-0	OR223	3387	SIMMONS GARY L & TERESSA L	R13 T10 S24 SD 34	0.14
010-000-490-4	OR228	2358	SMITH GENE L	R13 T10 S24 SD 49	0.582
010-000-490-2	OR211	1688	SWINGLE JULIA A & RANDALL W	R13 T10 S24 SD 47	0.772
010-000-490-1	OR211	1688	SWINGLE JULIA A & RANDALL W	R13 T10 S24 SD 46	2.295

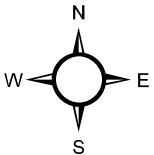

Boundaries	
	Lot
	ROW
	Section
	Roads
	Hidden
	Township
	County
	Sections
	Parcels

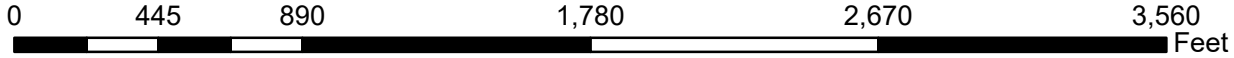

Disclaimer: The Information that these maps contains is for reference purposes only. Please bring any errors to the attention of the Engineer's Office staff. Thank You

Morgan County Engineer's Office
Author: Marcia Wolfe
Date: 7/20/2020